



1, 2 & 3BHK ULTRA LUXURY APARTMENTS
@ KIADB, AEROSPACE PARK, BAGALUR, BNAGALORE



SITE ADDRESS:
Plot No R-9-B, Hitech Defence Aerospace
Park (Hardware Sector),
Opposite Brigade El Dorado Gummanahalli
North Bangalore - 562149.

CONTACT:
903 698 5176 | 974 070 9787 | 900 831 6004

RERA NO: PRM/KA/RERA/1251/472/PR/091024/007138



RETURN TO A PLACE OF JOY

RERA NO: PRM/KA/RERA/1251/472/PR/091024/007138

**WE DESIGN SPACES THAT BRING
EVERYDAY HAPPINESS, FOSTERING A
SENSE OF COMMUNITY, UNITY, AND
BELONGING IN EVERY HOME.**



Let's cherish the
little moments of Every day
Joys right at home

WELCOMETO



1, 2 & 3BHK ULTRA LUXURY APARTMENTS
@ KIADB, AEROSPACE PARK, BAGALUR, BNAGALORE

**A HOME DESIGNED FOR YOUR
WELL-BEING,
WHERE EVERY DAY BEGINS AND ENDS
WITH HAPPINESS**



Discover NVG Rakshak, a landmark of luxury in Bangalore, offering a perfect balance of modern architecture and timeless elegance. Designed for discerning homeowners, NVG Rakshak is more than just a residence—it's a statement of prestige and comfort, crafted to meet the highest standards of luxury living.

ELEVATE YOUR LIFESTYLE,
EXPERIENCE LUXURY

MASTER PLAN



LEGEND

- 1. ENTRY /SECURITY CABIN
- 2. FLORAL GARDEN
- 3. PARKING GARDEN
- 4. EXIT /SECURITY CABIN
- 5. FAVILION LEISURE
- 6. ENTRY LAWN
- 7. BICYCLE STAND
- 8. WIDE DRIVEWAY
- 9. FLORAL GARDEN
- 10. INFORMAL SEATING
- 11. SAND PLAY
- 12. TOT LOT
- 13. HOP SKOTCH
- 14. DRIBBLE COURT
- 15. YOUTH CORNER
- 16. FRUIT ORCHIDS
- 17. PLAY EQUIPMENTS
- 18. ELDERS ZONE WITH GYM EQUIPMENT
- 19. AROMA GARDEN
- 20. CHIT CHAT CORNER
- 21. HERBAL GARDEN
- 22. CRICKET PITCH
- 23. PETS CORNER
- 24. PEBBLE GARDEN
- 25. BUTTERFLY GARDEN
- 26. MULTIPURPOSE HALL
- 27. POOL DECK
- 28. SWIMMING POOL
- 29. TODDLERS POOL
- 30. GYM
- 31. INDOOR GAMES
- 32. WAITING LOUNGE
- 33. COMMERCIAL SPACE



UNIT PLANS

Vastu Compliant unit plans thoughtfully designed to ensure maximum indoor and outdoor spaces.

**3 BHK-
1045 TO 1550 SFT**

TYPE	CARPET AREA	SUPER BUILTUP AREA
3BHK	786 SFT	1045 SFT
3BHK	789 SFT	1050 SFT
3BHK	929 SFT	1235 SFT
3BHK	978 SFT	1300 SFT
3BHK	1052 SFT	1400 SFT
3BHK	1057 SFT	1405 SFT
3BHK	1162 SFT	1545 SFT
3BHK	1166 SFT	1550 SFT

3BHK WEST

UNIT NO	09, 22
CARPET AREA	786 SFT
SUPER BUILTUP AREA	1045 SFT



3BHK NORTH

UNIT NO	10, 11
CARPET AREA	789 SFT
SUPER BUILTUP AREA	1050 SFT





3BHK WEST

UNIT NO	23
CARPET AREA	929 SFT
SUPER BUILTUP AREA	1235 SFT



3BHK EAST

UNIT NO	25
CARPET AREA	929 SFT
SUPER BUILTUP AREA	1235 SFT



3BHK EAST

UNIT NO	26
CARPET AREA	929 SFT
SUPER BUILTUP AREA	1235 SFT



3BHK WEST

UNIT NO	24
CARPET AREA	929 SFT
SUPER BUILTUP AREA	1235 SFT





3BHK WEST

UNIT NO	05
CARPET AREA	978 SFT
SUPER BUILTUP AREA	1300 SFT



3BHK EAST

UNIT NO	07
CARPET AREA	978 SFT
SUPER BUILTUP AREA	1300 SFT



3BHK EAST

UNIT NO	08
CARPET AREA	978 SFT
SUPER BUILTUP AREA	1300 SFT



3BHK WEST

UNIT NO	06
CARPET AREA	978 SFT
SUPER BUILTUP AREA	1300 SFT





3BHK WEST

UNIT NO	27
CARPET AREA	1057 SFT
SUPER BUILTUP AREA	1405 SFT



3BHK EAST

UNIT NO	29
CARPET AREA	1052 SFT
SUPER BUILTUP AREA	1400 SFT



3BHK EAST

UNIT NO	30
CARPET AREA	1057 SFT
SUPER BUILTUP AREA	1405 SFT



3BHK WEST

UNIT NO	28
CARPET AREA	1052 SFT
SUPER BUILTUP AREA	1400 SFT





3BHK WEST

UNIT NO	01
CARPET AREA	1166 SFT
SUPER BUILTUP AREA	1550 SFT



3BHK EAST

UNIT NO	03
CARPET AREA	1162 SFT
SUPER BUILTUP AREA	1545 SFT

3BHK WEST

UNIT NO	02
CARPET AREA	1162 SFT
SUPER BUILTUP AREA	1545 SFT

3BHK EAST

UNIT NO	04
CARPET AREA	1166 SFT
SUPER BUILTUP AREA	1550 SFT



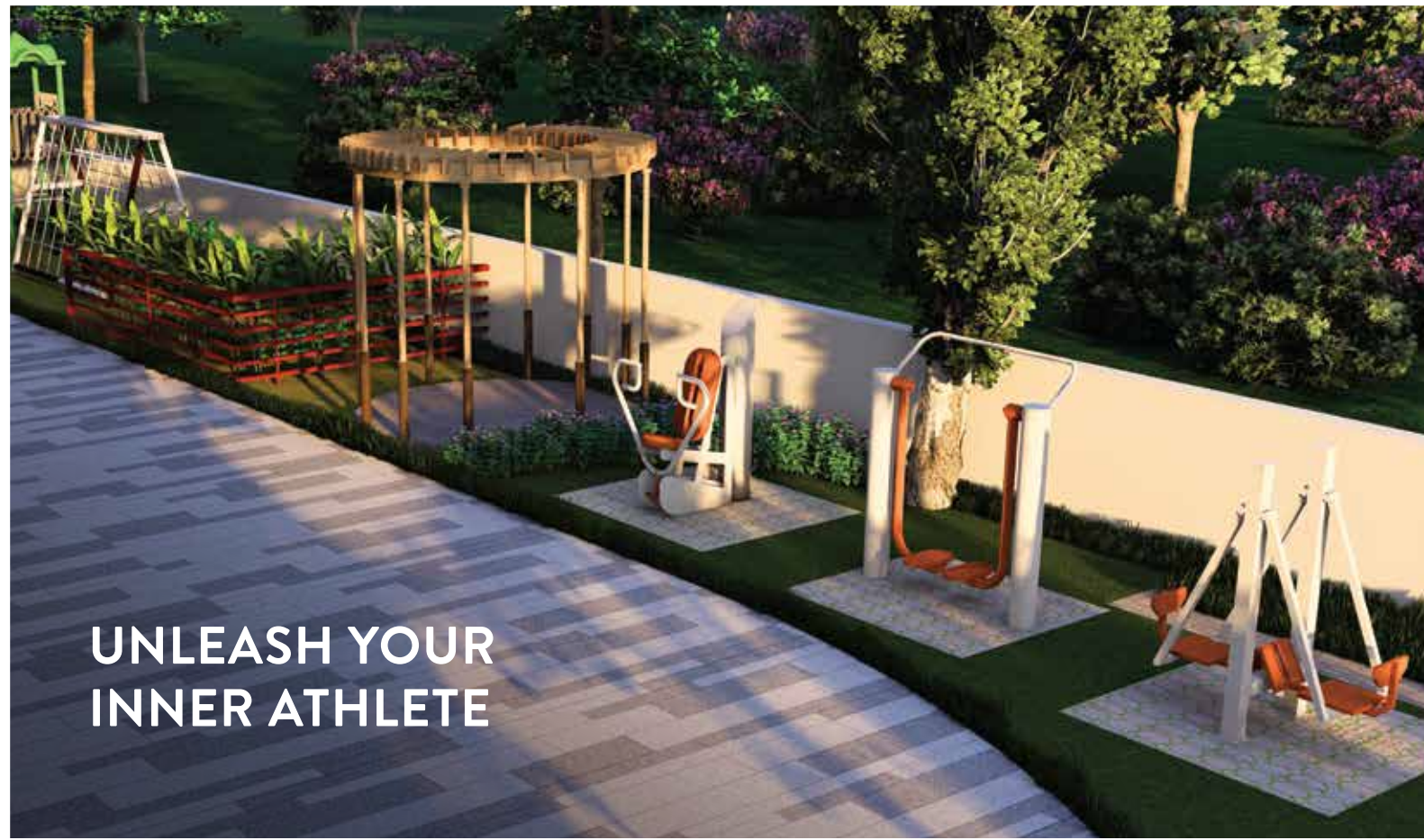

UNLEASH YOUR
INNER ATHLETE

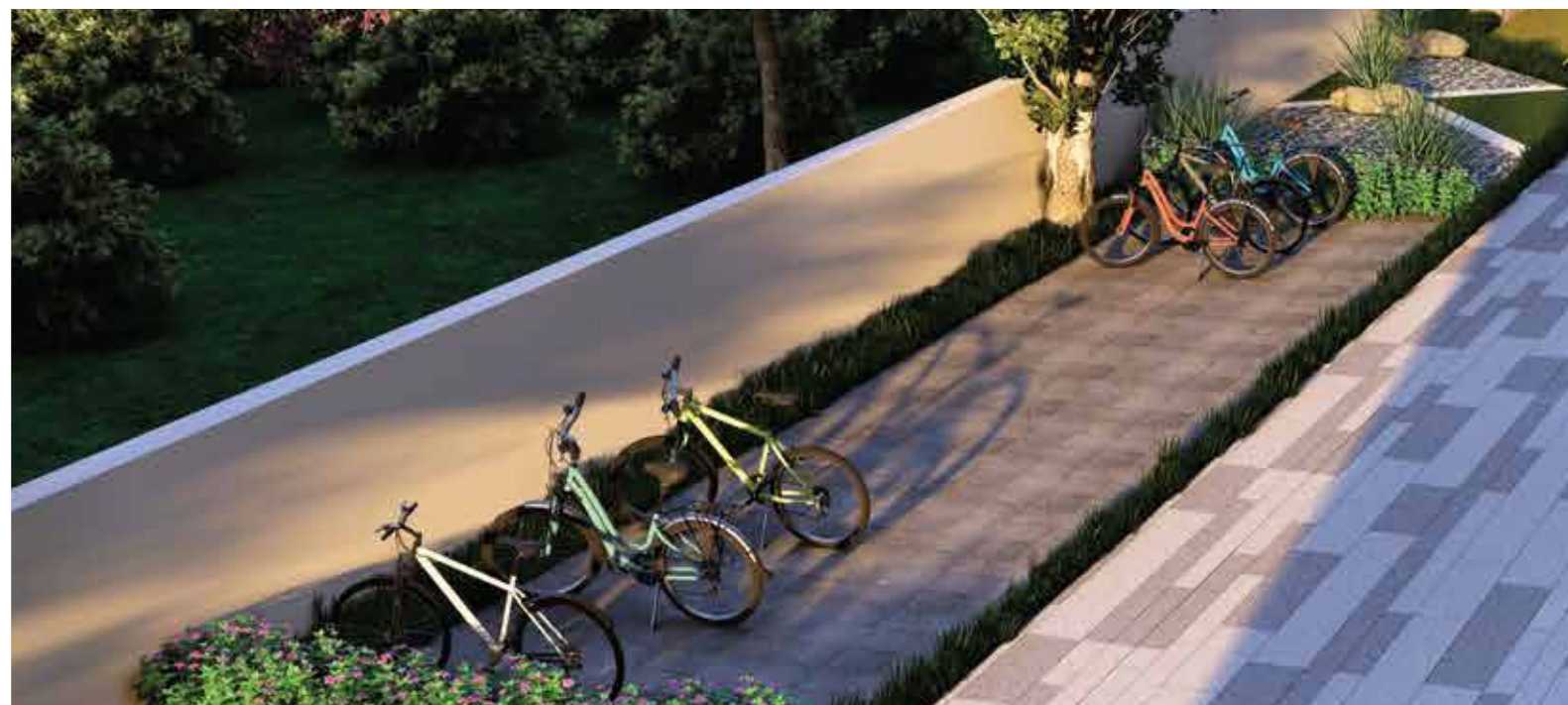

REDEFINING URBAN LUXURY IN BANGALORE

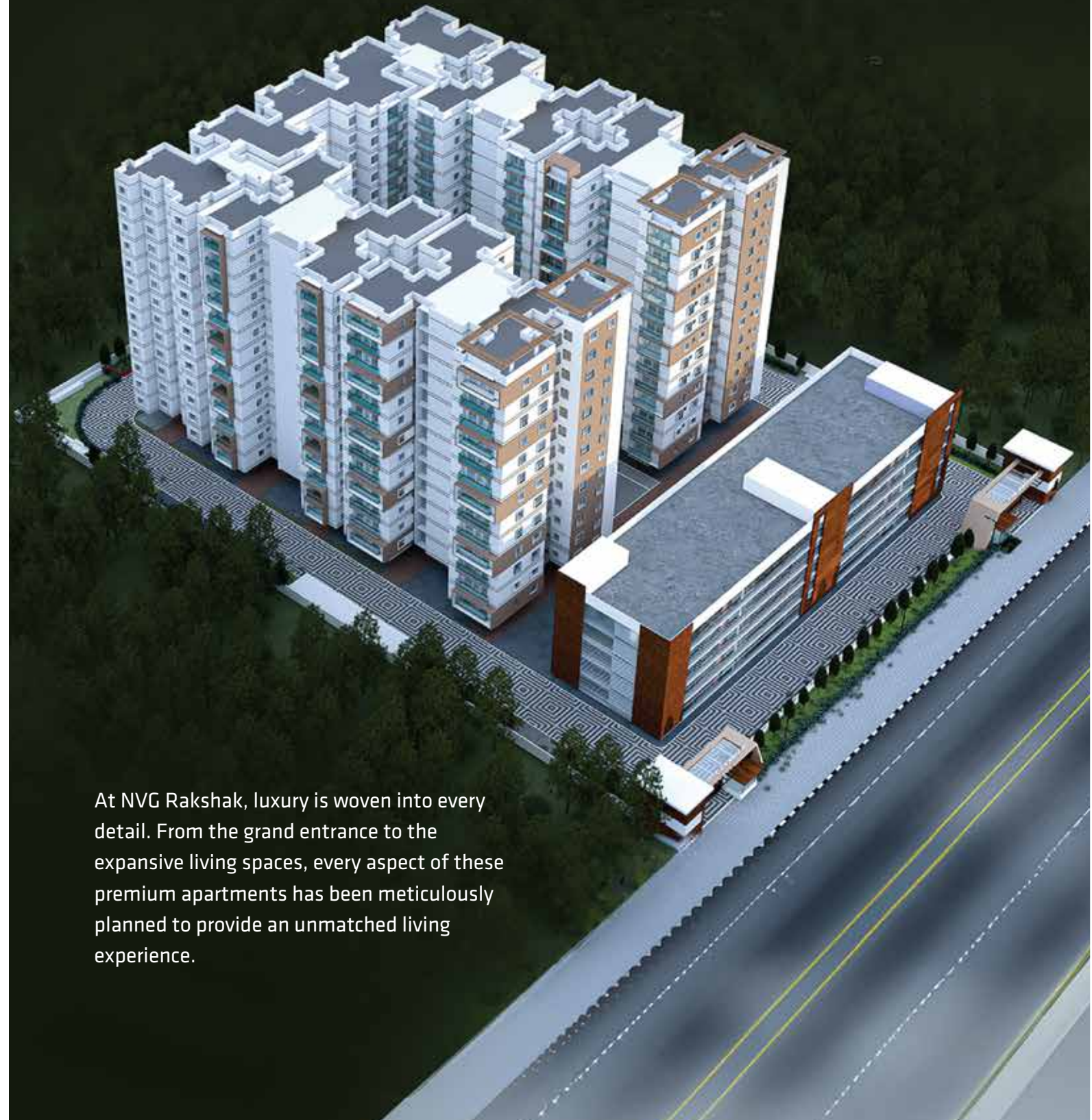

At NVG Rakshak, luxury is woven into every detail. From the grand entrance to the expansive living spaces, every aspect of these premium apartments has been meticulously planned to provide an unmatched living experience.

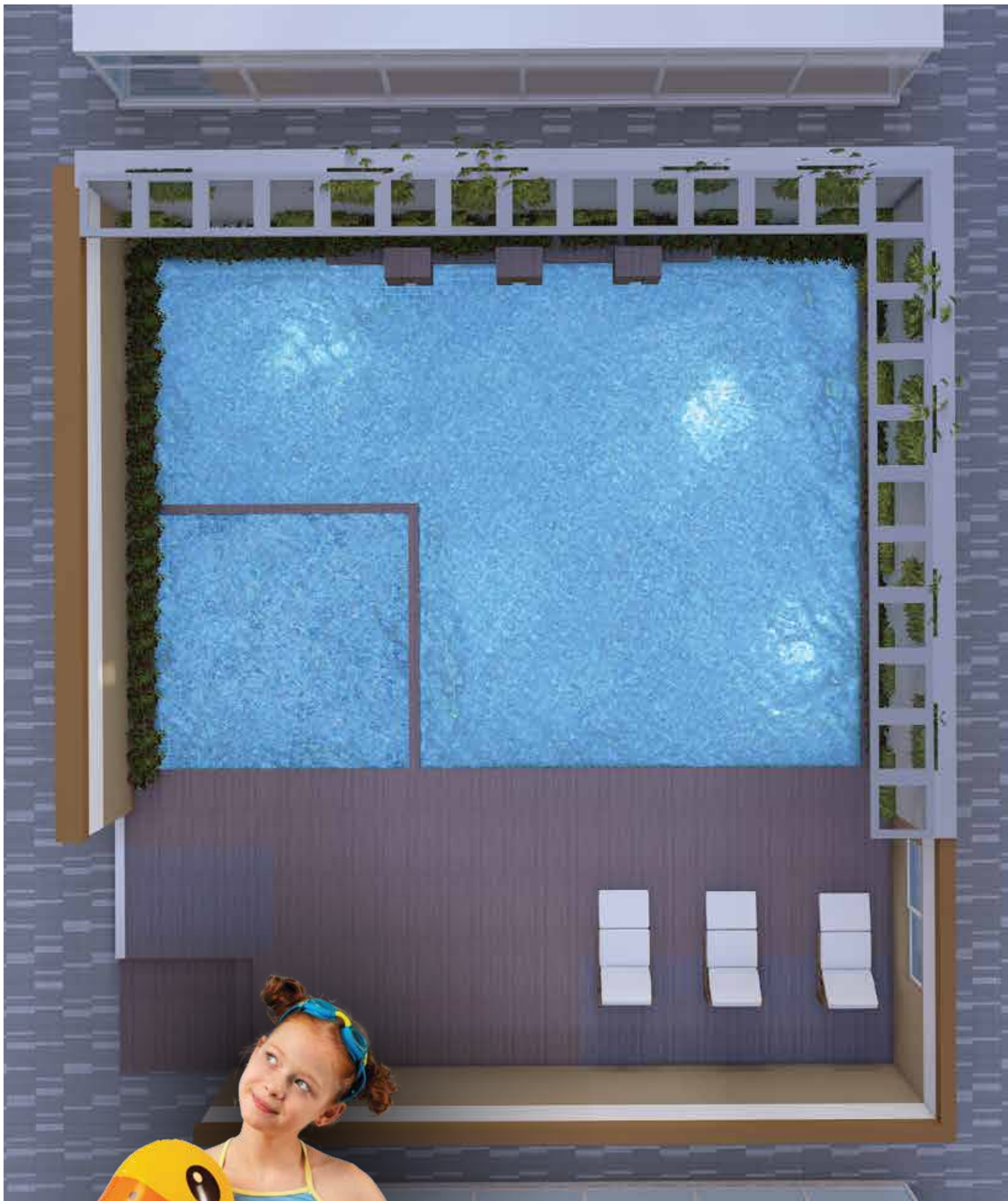

**DIVE INTO LUXURY,
EVERY DAY**

SPECIFICATIONS

STRUCTURE:

RCC Steel framed structure

COMMON AREA - FLOORING:

- Staircase; Concrete step tile / Granite / Vitrified tiles (cera / kajaria/ somany / orient or equivalent).
- Other lift lobby and corridors; Granite / Vitrified tiles (cera / kajaria / somany / orient or equivalent).

APARTMENT UNITS - FLOORING:

Living area, Dining, Bedrooms & Kitchen; Vitrified tiles (cera / kajaria / somany / orient or equivalent).

Balcony Area; Anti-skid Vitrified tiles (cera / kajaria / somany / orient or equivalent).

Toilets; Anti-skid Vitrified tiles (cera / kajaria/ somany / orient / equivalent).

WALL DADDO:

Toilet walls; Vitrified tiles upto beam level (cera / kajaria / somany/ orient or equivalent).

KITCHEN:

Counter Slab; 30mm Granite and 2feet wall daddo above the kitchen granite slab level.

PLUMBING AND ELECTRICAL:

- Plumbing point provision for water purifier, washing machine.
- Electrical point provision for water purifier, refrigerator, hob, chimney, mixer / grinder, microwave oven and washing machine.

SECURITY SYSTEM AND AUTOMATIONS:

Provision for Intercom facility and CCTV as per Design.

SUSTAINABILITY:

Ground water recharging, Rainwater storage, Street light and STP.

DG BACKUP:

- 3Bedroom Apartments ;0.75KW
- 2Bedroom Apatments ; 0.50KW

VERTICAL TRANSPORTATION:

Lifts; OTIS / JOHNSON / KONE / SCHIENDLER.

WINDOWS:

UPVC

DOORS:

- Door Frame** - Teak wood or Equivalent.
- Door Shutters** - Flush shutter with both side laminate and architrave.
- Bedroom Shutters - Particle board with half skin and architrave.
- Toilet Shutters - Shutter laminated both side laminate and architrave.
- Balcony Door - UPVC.

WIRING AND SWITCH SOCKETS:

- Wire materials; Havells / Anchor / Polycab / Finolex with Tested specifications as per IS- Standards.
- Switch sockets; Havells / Anchor / Cona or Equivalent.

PLUMBING:

CPVC and PVC; Ashirvad / Astral/ Prince / Supreme / Apoorva.

TOILETS:

CP and Sanitary Fittings; Floor mounted White EWC (Hindware / Parryware / Cera or Equivalent).

PAINTING AND FINISHING:

- Accessories; Combination of external texture paint with external grade emulsion.
- Internal ceiling and common area; Oil bound distemper or emulsion.
- Internal wall, common area and lift lobby; Emulsion paint.
- Staircase, Utility area and service area; Oil bound distemper.
- Unit walls; Acrylic emulsion paint.
- Steel works; Synthetic enamel paint.
- Wood works; Enamel paint.

ELECTRICALS:

- 3Bedroom Apartments ; 3KW
- 2Bedroom Apatments ; 2KW



LOCATION Nearby Landmarks

Tech Parks / Work Spaces

- Wipro Aerospace
- Manyata Tech Park
- Karle Town Centre SEZ
- L&T Tech Park
- Kirloskar Business Park
- Shell Technology Centre
- Boeing
- Foxconn
- Thyssenkrupp
- Financial City
- Brigade Magnum

Schools and Colleges

- Reva University
- CRM University
- Delhi Public School
- National Public School
- Greenfield Int School
- Canadian Int School
- Chrysalis School
- Presidency College
- Presidency University
- Presidency School

Hospitals

- Aster Hospital
- Columbia Asia
- Regal Hospital

Shopping / Malls

- Mall of Asia
- Esteem Mall
- Elements Mall
- Bhartiya Mall
- Galleria Mall
- Lulu Value Mart

Others

- Bangalore International Airport
- Byg Brewski
- Decathlon
- Hebbal Flyover