



**Address**

Sy.no:21, Sri Chikkanna, Bodanahosahalli Main Road, Anagondana  
Hobli, Hoskote Taluk, Thirumalasettihalli, Bengaluru - 560067

RERA : PRM/KA/RERA/1250/304/PR/030524/006836

Scan QR code for the Location



**Contact**

Ph : +91 7996 00 44 99  
Info@ishacorp.in  
WWW.ISHAHILIFE.COM

Disclaimer: This is only conceptual presentation of project and not a legal offering.  
The promoters reserve the right to make changes in elevation, plans and specifications as deemed fit.

EXPERIENCE UNBOUNDED FREEDOM



ULTRA LUXURY RESIDENCES

RERA: PRM/KA/RERA/1250/304/PR/030524/006836

REDEFINING LUXURY LIVING BY  
CRAFTING

# TIMELESS

LEGACIES

Welcome to Isha Hi Life, where luxury meets innovation in every meticulously crafted dimension. With a dedication to blending homes seamlessly with exceptional amenities, we redefine community living with vibrant spaces where comfort and elegance intertwine effortlessly.

Our seasoned team of visionaries ensures each project transcends the ordinary, becoming architectural marvels that stand as legacies of our commitment to excellence. At Isha Hi Life, expect nothing short of extraordinary – where sumptuous comfort and meticulous precision converge to create residences that are not just homes, but enduring symbols of sophistication and quality.

**2.5**  
ACRES OF LAND

**208**  
EXQUISITE 2 & 3 BHK HOMES

**70%**  
OPEN SPACES

**100%**  
VAASTU COMPLIANCE

**B+S+13**  
STORY BUILDING

**20,000**  
SQ FT CLUBHOUSE/INFINITY AMENITIES



ELEVATE YOUR  
**LIFE STYLE**  
TO NEW HEIGHTS

Embark on an unforgettable journey with us as we unveil the marvel that is Isha Hi Life, a sanctuary of luxury living nestled in the thriving heart of Whitefield. This meticulously planned project is more than just a residence; it's a lifestyle crafted for your utmost comfort and convenience.

Designed to cater to individuals of all ages, Isha Hi Life promises a holistic living experience with amenities tailored for kids, middle-aged adults, and senior citizens alike. Spread across **2.5 acres**, the project features **208 exquisite 2 & 3 BHK homes** housed within a towering structure, offering **70% open spaces** and **100% Vaastu compliance**. Immerse yourself in luxury with over **45 themed amenities** and a sprawling **20,000 sq ft clubhouse** with infinite amenities, where every corner is infused with tranquility and wellness.



# MASTER PLAN

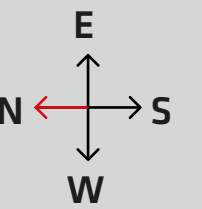

- |    |              |    |                          |    |                      |    |                    |    |                      |    |                   |
|----|--------------|----|--------------------------|----|----------------------|----|--------------------|----|----------------------|----|-------------------|
| 01 | ENTRY        | 07 | 6'-0" WIDE WALKING TRACK | 13 | PET LAWN             | 19 | COVERED PARTY HALL | 25 | YOGA/MADITATION HALL | 31 | OPEN AMPHITHEATRE |
| 02 | EXIT         | 08 | CRICKET PRACTICE NET     | 14 | PERGOLA              | 20 | WOODEN DECK        | 26 | ROOF TOP SITTING     | 32 | A.C. COVERED GYM  |
| 03 | SEATING DECK | 09 | 8'-0" WIDE CYCLING TRACK | 15 | SENIOR FITNESS AREA  | 21 | INFINITY POOL      | 27 | GAZIBO               | 33 | COMMERCIAL        |
| 04 | OPEN LAWN    | 10 | CHILDREN'S PLAY AREA     | 16 | BADMINTON COURT      | 22 | KIDS POOL          | 28 | INDOOR GAME & SPA    |    |                   |
| 05 | PERGOLA      | 11 | SKATING RINK             | 17 | VISITORS CAR PARKING | 23 | OPEN FITNESS AREA  | 29 | CAFETERIA            |    |                   |
| 06 | TREE SIT OUT | 12 | HALF BASKET BALL COURT   | 18 | OPEN PARTY HALL      | 24 | KIDS ACTIVITY AREA | 30 | BIRDS GAZE           |    |                   |



Stay in top shape with our cutting-edge gym and refreshing swimming pool. Get your adrenaline pumping with friendly matches at our sports facilities or unwind with pals at our exclusive club. Indoor enthusiasts fear not – we've got a plethora of indoor games to keep you entertained.

Your safety is our utmost concern, which is why we provide round-the-clock security services for your peace of mind.

DISCOVER  
**UNMATCHED**  
COMFORT AT ISHA HI LIFE

Immerse yourself in a world of luxury at Isha Hi Life. Prepare to be spoiled for choice with our exquisite range of amenities. Take a plunge into tranquility with our rooftop infinity pool or unwind amidst panoramic city views in our rooftop haven. Elevate your parking experience with our convenient elevated parking facilities.



# FUSION OF SOPHISTICATED DESIGN & CONTEMPORARY STYLE

Experience the extraordinary at Isha Hi Life, where design excellence and boundless creativity intersect. Rejecting the mundane, we've sculpted a masterpiece. Every facet is meticulously crafted to defy convention, weaving the narrative of Isha Hi Life into the fabric of unforgettable moments.

Our design ethos harmonizes comfort with exhilaration, turning nights into lively celebrations and mornings into refreshing wellness odysseys. Embrace a symphony of endless possibilities that beckon you forth.

SERIES	01	02 & 03	04	05	06	07	08	09	10	11, 12, 13, 14 & 15	16
TYPE	2BHK	3BHK	2BHK SMART	2BHK SMART	3BHK	3BHK SMART	2BHK	3BHK	3BHK SMART	3BHK SMART	3BHK
FACING	WEST	NORTH	WEST	WEST	WEST	WEST	NORTH	WEST	EAST	EAST	EAST
SBA	1221 Sft.	1465 Sft.	841 Sft.	844 Sft.	1465 Sft.	1539 Sft.	1140 Sft.	1571 Sft.	1478 Sft.	1421 Sft.	1482 Sft.

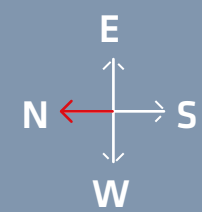

## 2BHK West



Series	SBA	CA
<b>01</b>	<b>1221 sft</b>	<b>731 sft</b>

## 3BHK NORTH



Series	SBA	CA
<b>02 &amp; 03</b>	<b>1465 sft</b>	<b>951 sft</b>

## 2BHK SMART West



Series	SBA	CA
<b>04</b>	<b>841 sft</b>	<b>528 sft</b>

## 2BHK SMART West



Series	SBA	CA
<b>05</b>	<b>844 sft</b>	<b>562 sft</b>

## 3BHK West

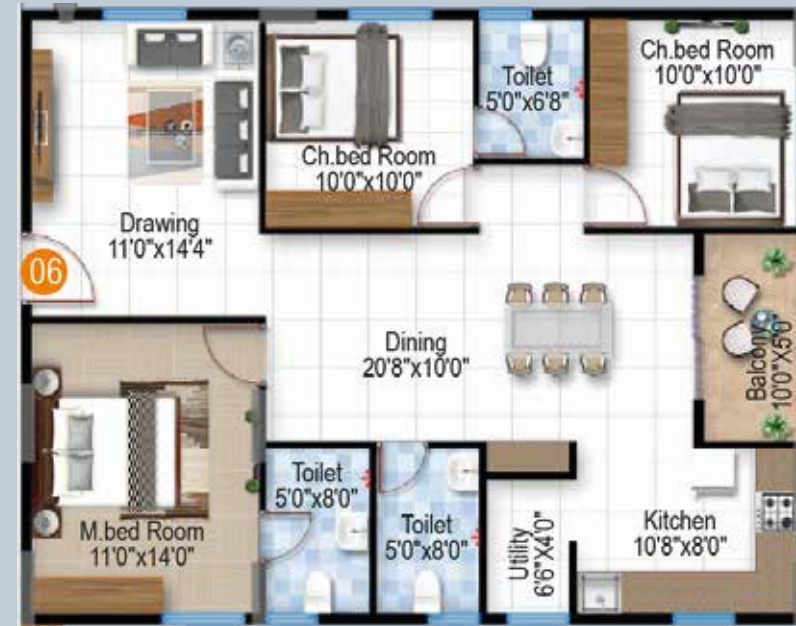

Series	SBA	CA
<b>06</b>	<b>1465 sft</b>	<b>949 sft</b>

## 3BHK SMART West

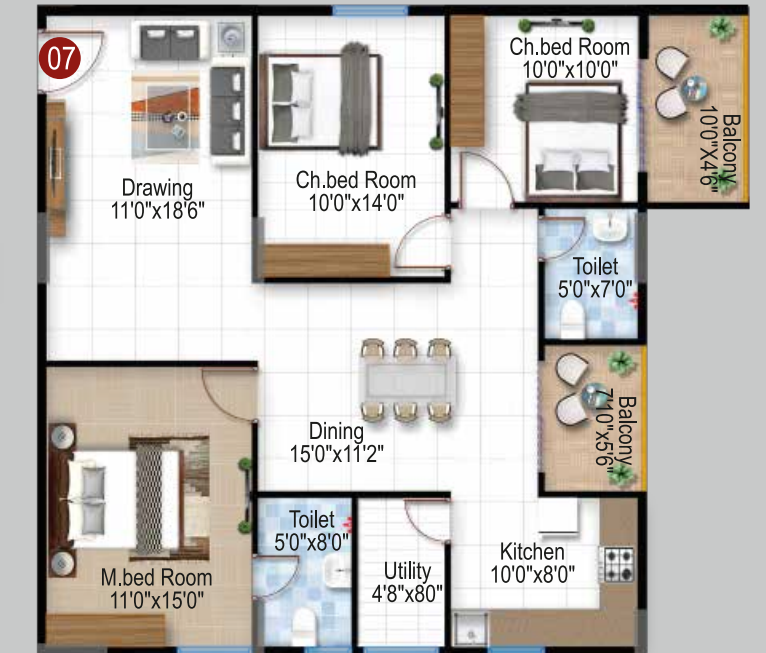

Series	SBA	CA
<b>07</b>	<b>1539 sft</b>	<b>958 sft</b>



## 2BHK North



Series	SBA	CA
<b>08</b>	<b>1140 sft</b>	<b>729 sft</b>

## 3BHK West



Series	SBA	CA
<b>09</b>	<b>1571 sft</b>	<b>1016 sft</b>



# 3BHK SMART East



Series	SBA	CA
<b>10</b>	<b>1478 sft</b>	<b>898 sft</b>

# 3BHK SMART East



Series	SBA	CA
<b>11, 12 &amp; 13</b>	<b>1421 sft</b>	<b>859 - 863 sft</b>



# 3BHK SMART East



Series	SBA	CA
<b>14 &amp; 15</b>	<b>1421 sft</b>	<b>860 &amp; 859 sft</b>



# 3BHK East



Series	SBA	CA
<b>16</b>	<b>1482 sft</b>	<b>901 sft</b>



UNVEILING ISHA HI LIFE'S

# SIGNATURE HIGHLIGHTS

Step into the realm of Isha Hi Life and discover a world brimming with conveniences tailored to elevate your lifestyle. There's an experience awaiting every member of the family. Dive into the future with our Smart Homes, where cutting-edge technology seamlessly integrates into every corner.

Seek solace in our Rooftop Paradise, where urban hustle fades into a tranquil retreat. Immerse yourself in luxury with our Terrace Infinity Pool, offering an oasis high above the city skyline. And with our Elevated Parking Experience, convenience reaches new heights, ensuring hassle-free arrivals and departures.



AMENITIES

# BEYOND COMPARE

At Isha Hi Life, we've designed a haven of delights for everyone, from the young to the young at heart. Our dedicated spaces cater to all ages, ensuring that every resident can enjoy life to the fullest. With over 45 diverse amenities, there's something for everyone to indulge in, whether it's fitness, leisure, or simply finding moments of serenity.



## EXCLUSIVE AMENITIES LIST

- |  |  |  |   |   |
|--|--|--|---|---|
| <br>Waiting Lounge        | <br>Designer Landscape            | <br>Seating Deck              | <br>6'-0' wide Walking Track | <br>8'-0' wide Cycling / Jogging Track |
| <br>Tree Sitout           | <br>Elder's Lawn                  | <br>Covered Seating Deck      | <br>Cricket Practice Pitch   | <br>Childrens' Play Area               |
| <br>Skating Practice Rink | <br>Half Basket Ball Court        | <br>Gazebo                    | <br>Badminton Court          | <br>Pets Lawn                          |
| <br>Communal Seating     | <br>Infinity Pool & Toddler Pool | <br>Yoga Deck                | <br>Pergola Seating         | <br>Indoor Gym                        |
| <br>Outdoor Gym         | <br>Senior Citizen Gym          | <br>Spa/Refreshment Counter | <br>Outdoor Party Area     | <br>Cafeteria                        |
| <br>Barbeque            | <br>Party Hall                  | <br>Open Amphitheatre       | <br>Birds Gaze             |   |

## BASIC AMENITIES LIST

- |  |                                     |
|--|-------------------------------------|
| 1. STP   | 6. 24*7 Security                    |
| 2. Water Softener Plant                            | 7. DG Power Backup                  |
| 3. Car Wash Point                                  | 8. Transformer Yard                 |
| 4. Provision for Electric Charging                 | 9. Hydraulic Car Parking Provisions |
| 5. CCTV Camera Surveillance near building premises |                                     |

# WHERE YOUR STORY

## BEGINS WITH ISHA HI LIFE

Embrace an upgraded living experience of elegance and sophistication at Isha Hi Life. Dare to stand out, embrace the extraordinary, and let your story unfold in a world beyond expectations.

Welcome to Isha Hi Life, where extraordinary living is your happily ever after.



INDULGE IN THE EPITOME OF  
OPULENCE WITH OUR TERRACE

# INFINITY

POOL

Perched high above the city skyline, this rooftop oasis offers a sanctuary of relaxation and rejuvenation. Immerse yourself in the tranquil waters as you soak in breathtaking panoramic views, creating unforgettable moments of bliss and serenity.



BADMINTON COURT

# EMBRACE

## ACTIVE LIVING AT ISHA HI LIFE

Dive into a world of wellness and vitality with our state-of-the-art outdoor sports facilities. Whether you're a badminton enthusiast, a cricket aficionado, or a basketball fanatic, our meticulously maintained courts provide the perfect setting for friendly matches and spirited competition

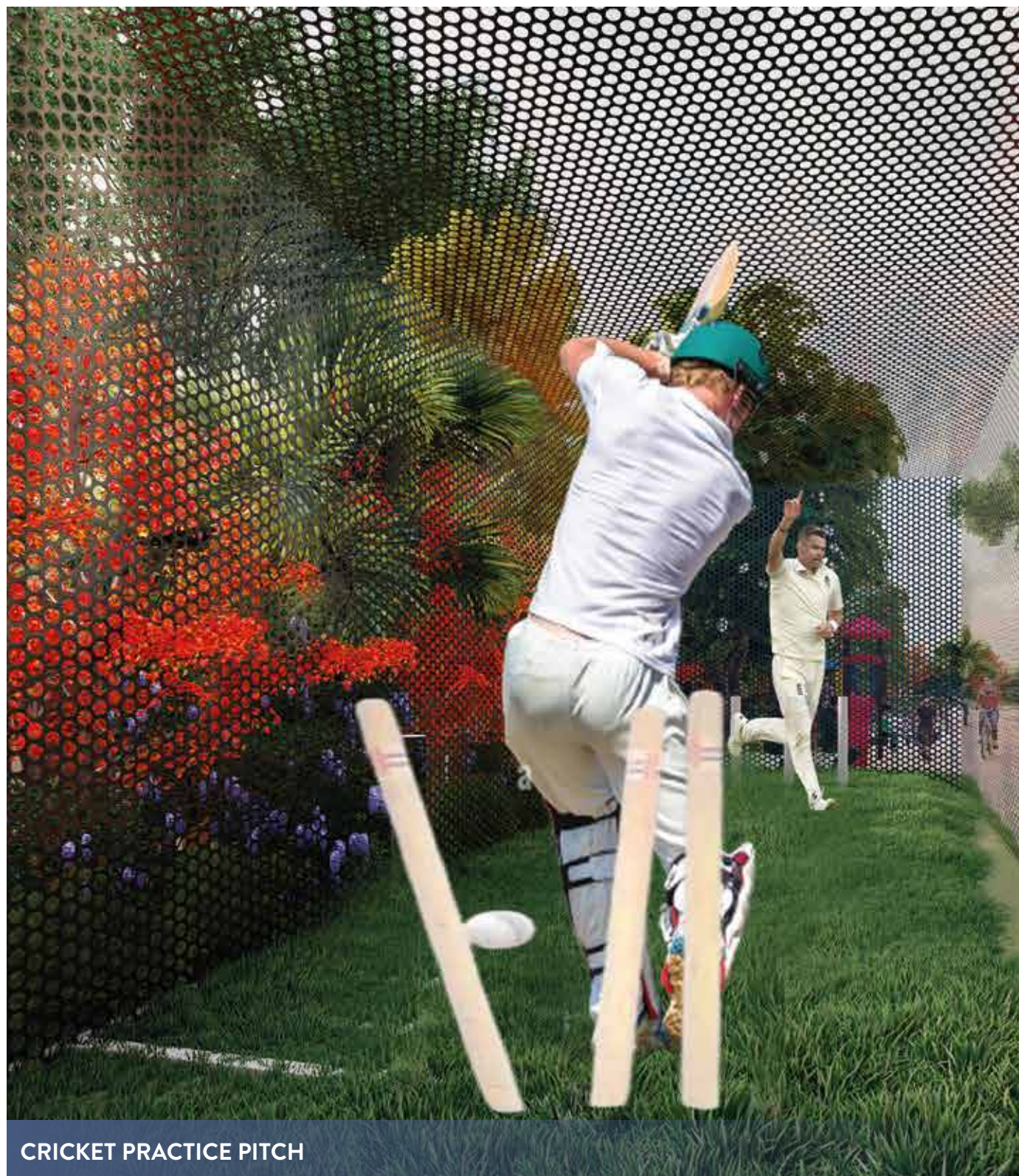

CRICKET PRACTICE PITCH



BASKET BALL COURT

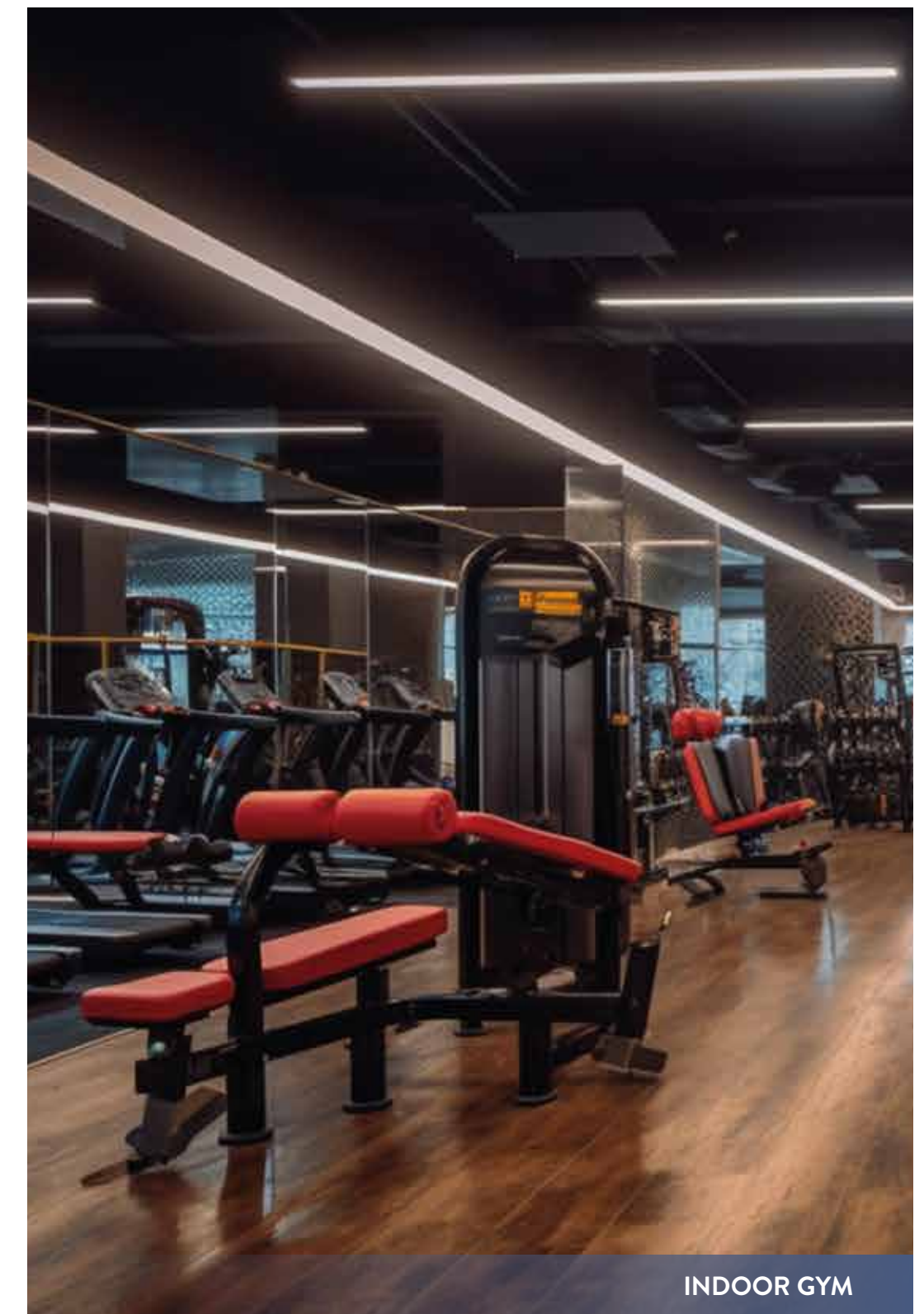

INDOOR GYM



PETS LAWN



GAZEBO



TARRACE SITOUT



OUTDOOR GYM



YOGA/MADITATION AREA

TAILORED SPACES FOR EVERY

# GENERATION

Our community is designed to cater to individuals of all ages, ensuring that every resident can find joy and fulfillment in their surroundings. For our cherished seniors, we have created dedicated spaces that prioritize their comfort, well-being, and leisure.

From serene gardens for relaxation to gentle exercise areas tailored to their needs, these spaces are thoughtfully crafted to promote active and vibrant living.

DIVE INTO A WORLD WHERE  
**NO LIMITS**



CHILDRENS' PLAY AREA



KIDS ACTIVITY ZONE



TODDLER POOL

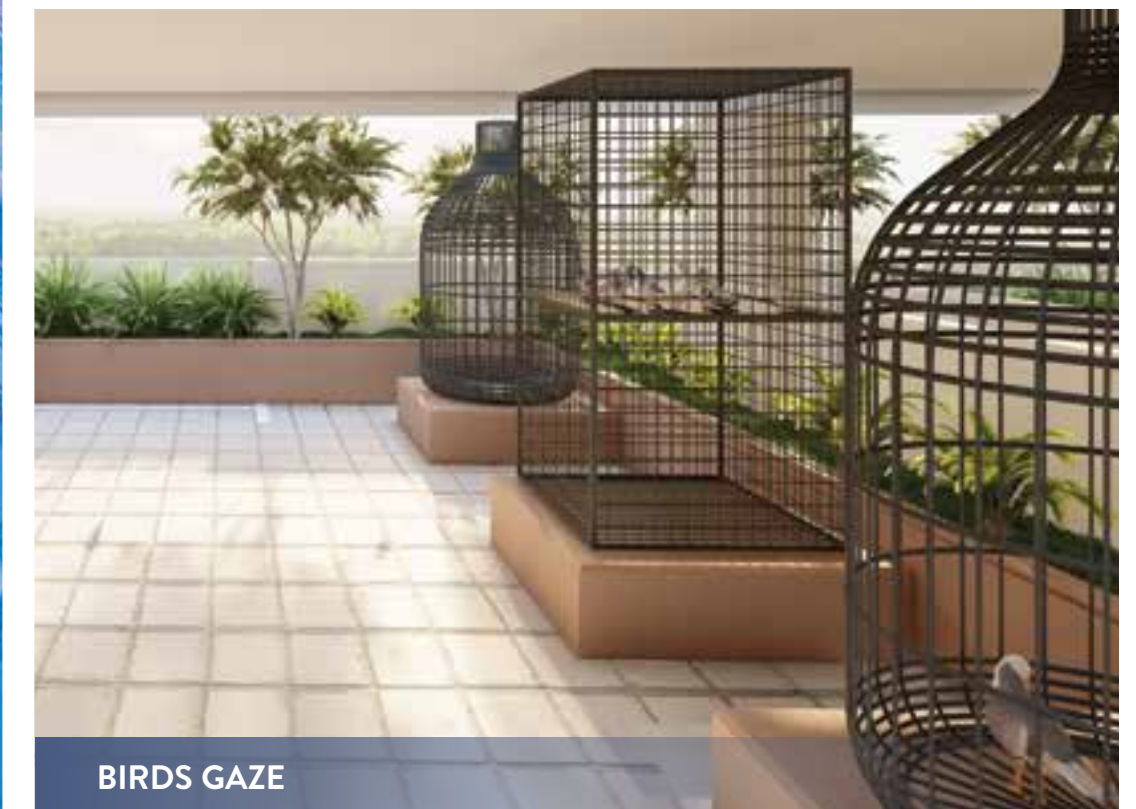

BIRDS GAZE



SKATING PRACTICE RINK



INDOOR GAME AREA

We've dedicated special areas just for kids, ensuring they have the perfect space to play, learn, and grow. From colorful playgrounds designed for imaginative adventures to interactive learning zones that spark creativity, our recreation areas are thoughtfully crafted to bring joy and excitement to young hearts.

With safety and fun in mind, parents can rest assured knowing their little ones are exploring and enjoying their surroundings in a space designed just for them.





OUTDOOR GYM

WHERE LUXURY MEETS

# SERENITY

Experience the pinnacle of urban living at ISHA Hi Life, where every detail is meticulously crafted to redefine luxury living. Nestled in the heart of whitefield, our exquisite apartment project offers a harmonious blend of modern elegance and tranquil surroundings.



OPEN AMPHITHEATRE



SPA/REFRESHMENT COUNTER



CAFETERIA



TREE SEATING

## MERGING COMMUNITY AND CONVENIENCE

Isha Hi Life stands as a beacon in Bengaluru's vibrant landscape, strategically nestled in the bustling heart of Whitefield. Where commerce meets community, it's a coveted address, drawing in those seeking the perfect fusion of work and life.

Close to major Tech parks, it's a magnet for professionals seeking balance. Moreover, Isha Hi Life is where families flourish, surrounded by top schools and renowned healthcare facilities.

Boasting an enviable location amidst the bustling hub of Whitefield, residents will find themselves surrounded by top-tier educational institutions, premier healthcare facilities, and an array of shopping and entertainment options. With seamless connectivity to Marathahalli and ITPL, coupled with easy access to metro and railway stations, every convenience is at your doorstep.



# PREMIUM

## SPECIFICATIONS

Experience the perfect blend of style and functionality, where premium materials and expert craftsmanship come together to create a home that exudes sophistication and refinement.



**Structure**  
RCC Framed structure

**Walls**  
6" thick outer cement walls;  
4" thick cement walls.

**Flooring**  
800x800mm tiles and Wooden  
flooring in master bedroom.

**Toilet**  
Anti-skid tiled flooring &  
matte finish 600X1200mm  
upto door height with  
sensor lights

**T.V. & Internet**  
T.V. & Internet point in Living  
& Master bedroom

**Car parking**  
Covered Basement and stilt car  
parking( basement with Hydraulic  
provision with EV Charging Point)

**Fittings**  
American standard &  
Grohe fittings

**Electrical work**  
Havells/ Polycab wire with  
Schneider Switches. 3 AC  
point will provided.

**Lift**  
Schindler /Equivalent  
automatic lift( 3 Nos.)

**Window & Door**  
UPVC Sliding windows  
with mosquito mesh  
provision

**Paint**  
Asian Paints

**Power Backup**  
D G backup

# BENGALURU'S FINEST DISCOVER

Explore the dynamic neighborhood and unlock a world of opportunities, from renowned dining spots to cultural hotspots. Experience the very best that Bengaluru has to offer, right at your doorstep.

## NEAR BY HOSPITALS

- Sri Sai Clinic 500m
- GR hospital 1.4km
- Nandini Hospital and Diagnostic Centre 1.9km
- Ashwathai Hospital 3km
- Ashwathaiya Poly Clinic 3.4km
- Heart&Super speciality hospital 3.6km
- Amrik Hospital 3.9km
- Sri Sathya Sai Super Speciality Hospital 4.7km
- Axis Hospitals, Belathur Village 5km
- Svastha Hospital 5.2km
- Cloudnine Hospital - Whitefield 6.4km
- Aster Whitefield Hospital 6.7km
- Aster Women & Children Hospital 6.7km
- Vydehi Hospital 7km
- Manipal Hospital Whitefield 7km
- Apollo Medical Centre Best Multi-Speciality Clinic 9.8km

## NEAR BY SUPER MARKETS

- Big Bazaar 6.6km
- D mart 8.7km

## NEAR BY TECH PARKS

- Sumadhura Capiton 3.6km
- HM Tech Park 4.4km
- GR Tech Park 4km
- ITPL 5km
- Prestige Shantiniketan Mall 6.5km
- Sigma Tech Park 7km
- Divyashree Tech park 8.5km
- SAP Labs India 8.5km
- Bearys Global Research Triangle 10km
- Bagmane Tech Park 12km

## NEAR BY TOP SCHOOLS

- Krish V School 50 m
- The Rising International School 1.3 km
- Bangalore International Academy 2.5km
- Whitefield Global School 2.9km
- Delhi Public School 3.8km
- Sri Ram Global School 3.9 km
- Winmore Academy 6.0km
- National Public School 6.1km
- KSVK International School 7.1km

## NEAR BY MALLS

- Nexus Mall (Forum Mall) Whitefield 6km
- Prestige Shantiniketan Mall 6.5km
- Inorbit Mall 7km
- Phoenix Marketcity 11km
- VR Shopping Mall 11km
- KLM Mall 12km

